

Hillsdale Heights Apartments

- ◆ Very spacious, well-designed floor plans
 - ◆ Washing machine and dryer in every unit for 1 & 2 bedrooms
 - ◆ Built-in microwave, dishwasher, and garbage disposal
 - ◆ Lots of windows and closets for ample storage
 - ◆ Short walking distance to excellent restaurants, shopping, and schools
 - ◆ Enjoy the year-round local Farmer's Market
 - ◆ Convenient access to Tri-Met bus lines 44, 45, 54, 55, 56, and express transit
 - ◆ Only minutes away from downtown Portland and freeways
 - ◆ No pets allowed to maintain a peaceful environment
 - ◆ Locally owned and operated for personalized service
 - ◆ Large secondary vehicle parking lot on site, eliminating the need to park on the public street
- ◆ **One free assigned covered parking space for each apartment**
 - ◆ **We cover water, sewer, and garbage expenses; no extra utility fees assessed**

TYPE "A"

807 SF, 1 Bed-1 Bath,
Bottom Floor \$1,300.00
Middle Floor \$1,325.00
Top Floor* \$1,350.00

TYPE "B"

1077 SF, 2 Bed-2 Bath
Bottom Floor \$1,600.00
Middle Floor \$1,625.00
Top Floor** \$1,650.00

TYPE "C"

979 SF, 2 Bed-2 Bath
Bottom Floor \$1,525.00
Top Floor \$1,550.00

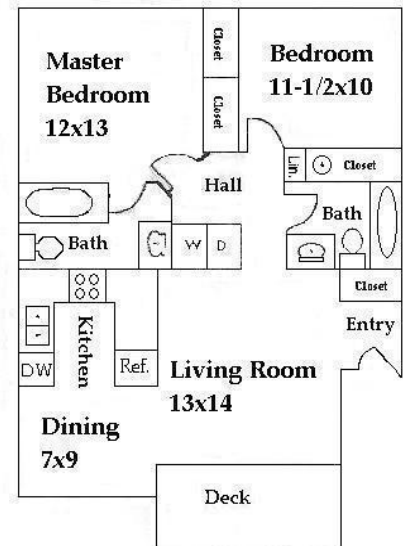

**Wood-burning fireplace and vaulted ceilings

* Vaulted ceilings

- Application Fee: \$75.00 Per Person (Non-refundable)
- Security Deposit: \$500 - 1 month rent * Depending on credit
 - Additional Security Deposit Due to Risk Factors:
 - Up to ½ month rent. * Depending on credit
- Lease terms: 1 Year

Office Hours

MON to FRI: 11:00am to 4:00pm

**If you would like to make an appointment
Please call: (503)293-0280*

**Messages are checked daily.*